

Elementy napędowe i sygnalizacyjne

Kształt kwadratowy

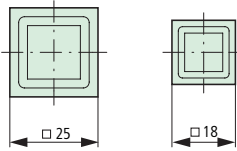

Q...BS

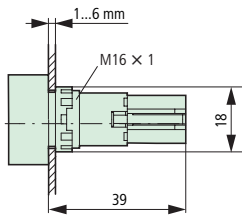
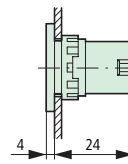

Q...D...Q...DR...

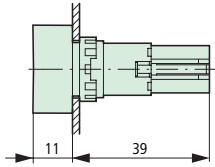

Q...S...

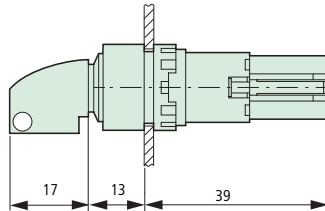

Q...WK...

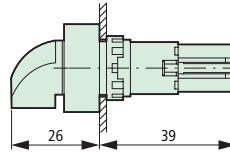

Q...LT...Q...LTR...Q...LF...

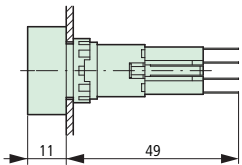

Q...LH...

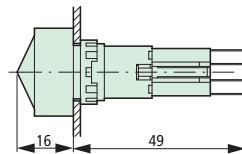

Q...LWK...

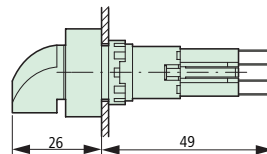

Q25PV...Q25LPV...

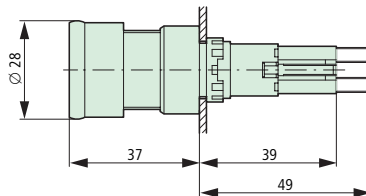
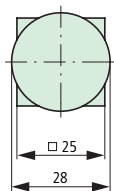

### Mocowanie do płyty czołowej

Q18, Q25, E89, SRA, VS, M16

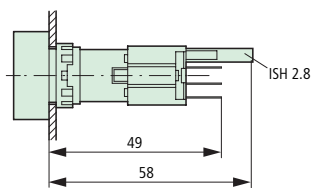
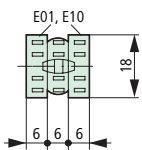

Wymiary otworów

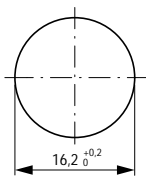

Wymiar rastra zgodnie z IEC/EN 60947

Q25...

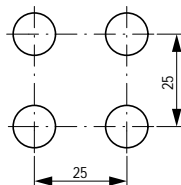

Minimalny wymiar rastra

Q18...

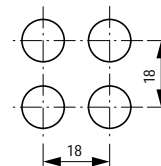

Odstępy montażowe

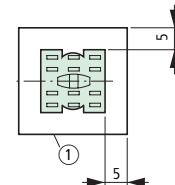

① Część przewodząca (metal)



